



## **700 Ultraflow Series Electric Valves**

### **Installation and Operating Instructions**

#### **FEATURES**

- Revolutionary new design permits a straight flow path providing minimal pressure loss and clogging.
- Manual operation is accomplished by a simple flip of the manual "bypass" lever with no external discharge of water to the atmosphere.
- Precision molded from high strength non-corrosive Celanese glass-filled nylon material.
- Built with quality materials including a Buna-N reinforced diaphragm, stainless steel springs and hardware.
- Flow control handle for precise flow control adjustment on 1", 1-1/2" and 2" models.

#### **SPECIFICATIONS**

- Connections: Available in 3/4", 1" 1-1/2", 2" female NPT
- Voltage: 24 VAC, 60 cycle, .48 Amps in rush current, .24 Amps holding current
- Operating pressure: 3/4" - 10 psi minimum to 125 psi maximum, 1", 1-1/2" and 2" - 10 psi minimum to 150 psi maximum
- Maximum operating temperature: 150° F

#### **INSTALLATION**

Flush the line thoroughly before installing the valve. Use three to five complete wraps of PTFE tape on the male pipe threads for a sealant. Tighten pipe into valve using a wrench. Water flow direction is indicated by the arrow on the top inlet side.

The Ultraflow Valves are supplied with a 24 VAC, 5.75 VA solenoid. Connect the leads only to a 24 VAC power source.

***WARNING: Never connect the solenoid leads directly to a 110 volt house current. Serious injury or electrocution could result.***

Care should be taken to insure that the system is kept free of debris and contaminants to assure positive valve operation.

For manual operation, simply turn the manual "bypass" lever (located under the solenoid) in the appropriate direction as noted on the lever. For automatic operation, always position the lever in the closed position.

**WARNING: Do not use "pipe dope" on the pipe to valve connections.**

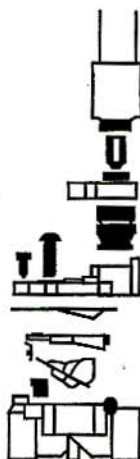

700-.75

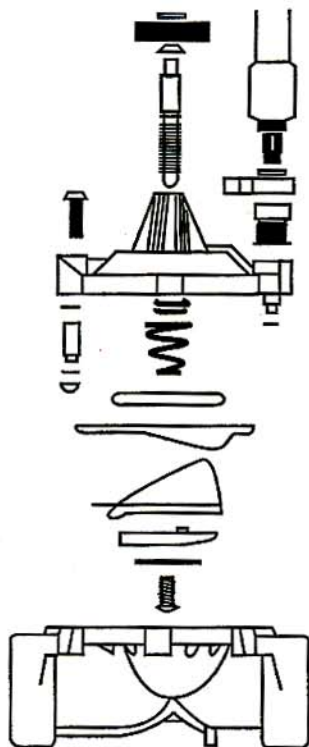

700-1, 1.5, 2

Product Inquiries  
P.O. Box 489  
Riverside, CA 92502  
1-800-634-8873

1048801 REV. B